

Discover the new horizon



sakshi
NISARGA
FLATS | BUNGALOWS | SHOPS

Life with nature...



Sakshi Construction



"A" WING

GROUND/PARKING FLOOR PLAN



TYPICAL FLOOR PLAN

"A" WING

(FIRST, SECOND, THIRD, FOURTH, FIFTH, SIXTH & SEVENTH FLOOR)



"B" WING

GROUND/PARKING FLOOR PLAN



TYPICAL FLOOR PLAN

"B" WING

(FIRST, SECOND, THIRD, FOURTH, FIFTH, SIXTH & SEVENTH FLOOR)

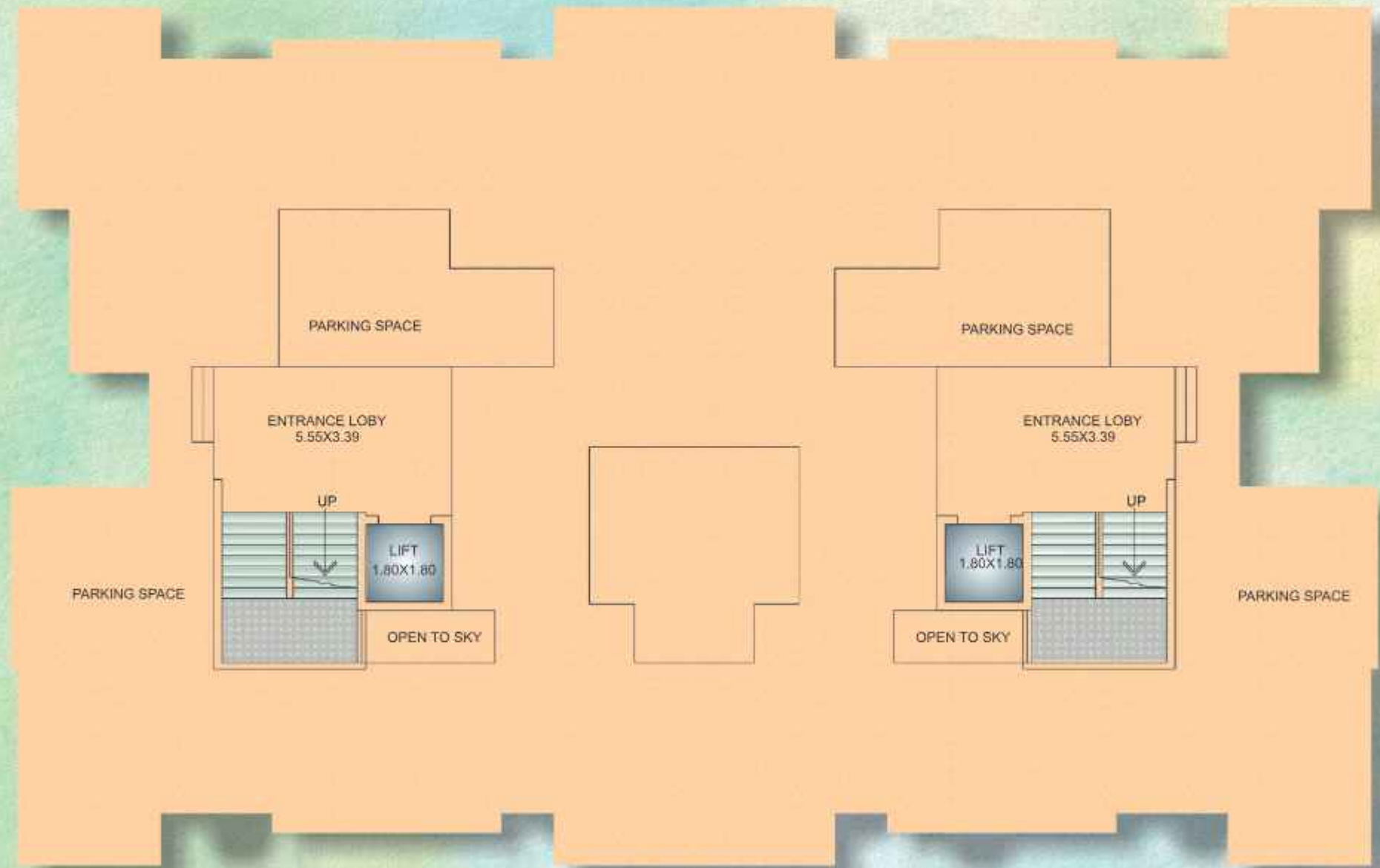

"C" WING
PARKING FLOOR PLAN



TYPICAL FLOOR PLAN

"C" WING

(FIRST, SECOND, THIRD, FOURTH, FIFTH, SIXTH, SEVENTH & EIGHTH FLOOR)



Independent Bungalow Floor plan & Cut Section



Ground Floor View



First Floor View



First Floor View



Ground Floor View

Premium Amenities : A better lifestyle

STRUCTURE

- Earthquake Resistant R.C.C. Framed Structure

MASONARY

- 6" mm thick internal walls with Neeru Finish Plaster and 6" mm thick external Walls with Sand Face Finish Plaster

FLOORING

- 600 mmX 600mm Vitrified Tiles Flooring in Entire Flat
- Antiskid Tiles Flooring for Toilets

KITCHEN

- Granite Kitchen Otta. With Stainless Steel Sink
- Designer Glazed Tiles 18" X 12" In Kitchen

DOORS

- Main Entrance door with Both side Laminate with Standard Fitting
- All Internal Flash Door with Both side Laminate Granite Door Frame for Toilet and Bath

WINDOWS

- Powder coated Aluminum Sliding windows with Safety Grills & mosquito mesh

PLUMBING

- Good Quality Concealed Plumbing

TOILETS/SANITARY

- Designer glazed tiles up to 7' height
- Provision For geyser & Solar Point
- Concealed plumbing With Premium High Quality C. P. Fittings

ELECTRIFICATION

- High Quality Concealed Copper Wiring with branded modular switches
- TV Point in Living room
- Invertor Wiring
- Electrical Provision for water Purifier in kitchen

PAINTING

- Premium Quality oil bound distemper to
- Entire flat
- Apex paint for external Surfaces



Lifestyle Amenities



Children's play area



Indoor game



Jogging track



Clubhouse



Ganpati Mandir



Amphitheater



Lift Power backup



Internal street lights



Fitness centre



Meditation area

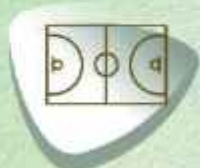

Multipurpose Sport Court



Kitchen Garden



Reflexology Garden



Flower Garden



Senior citizen sitout



Signage Board



Sculptures



Bird Nesting area

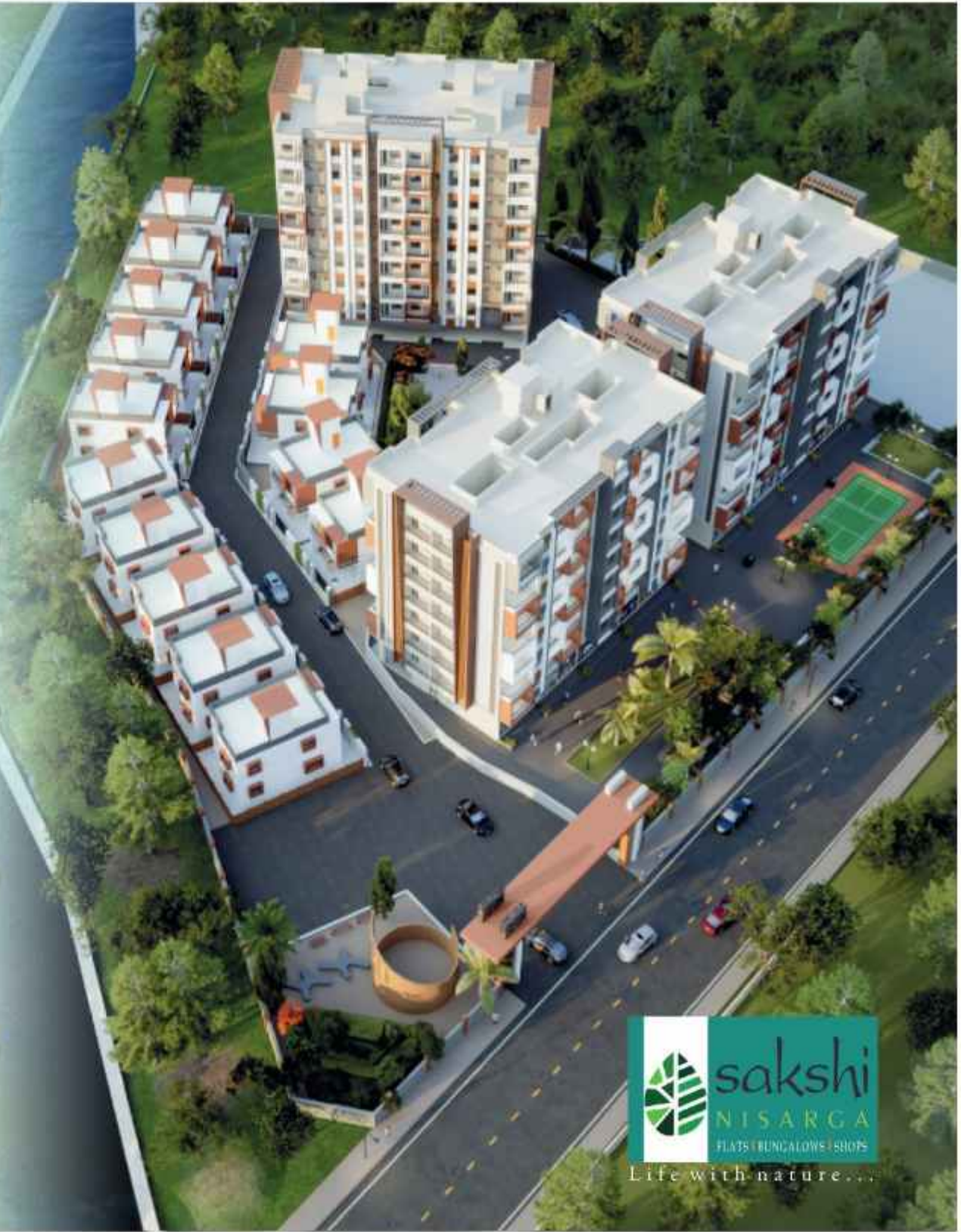

PLATS TRUNCALOWS SHOPS
Life with nature...



PS 2700047852



Life with nature...



Sakshi Construction

Booking Contact

9422600483 | 9006 6002- 43 | 9006 6002- 63 | 7083 00 -5100 |

sakshicon@rediffmail.com | sakshiconstruction24@gmail.com

Site Address

S.No. 68, Near Sandesh Resort, Wai-Bavdhan road,
Yashwantnagar, Wai. 412803

Office Address

Sakshi Construction. S. No 30 Near CBD Complex & Bhadreshwar
Bridge, Wai-Surur Road, Yashwantnagar, Wai. 412803

Credits

Architect and Designer: Mr. Prasad Kasture | **RCC Designer:** Mr. Shriram Kulkarni

Legal Advisor: Adv. Umesh Sanas | **Landscape and Interior designer -** Reshargranath architects pune